

Placing Duct

Abstract

This document will provide a step-by-step process to place duct in Revit MEP.

Procedure:

1. Link architectural file into Revit MEP file.

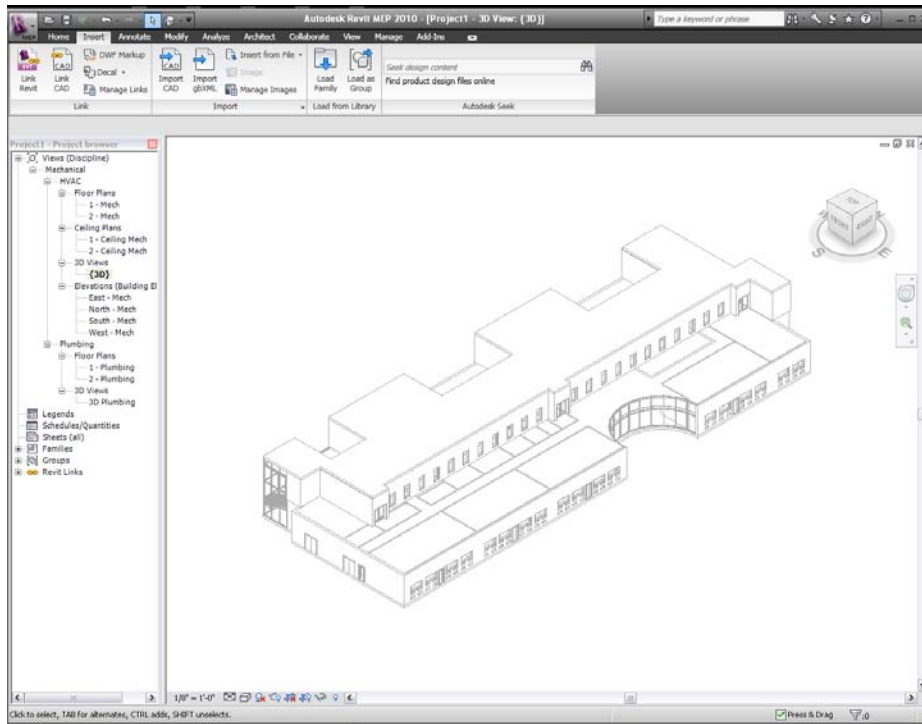

2. Floor plan, place mechanical equipment.
3. Connect duct from mechanical equipment to air terminal
4. Click on Home tab \Rightarrow HVAC panel \Rightarrow Duct

Change duct width, height and offset to equipment's inlet height (ex: 2') , then click apply.

Click on the equipment's inlet, draw a segment of the duct, and change the offset to the height of the ceiling (ex: 9')

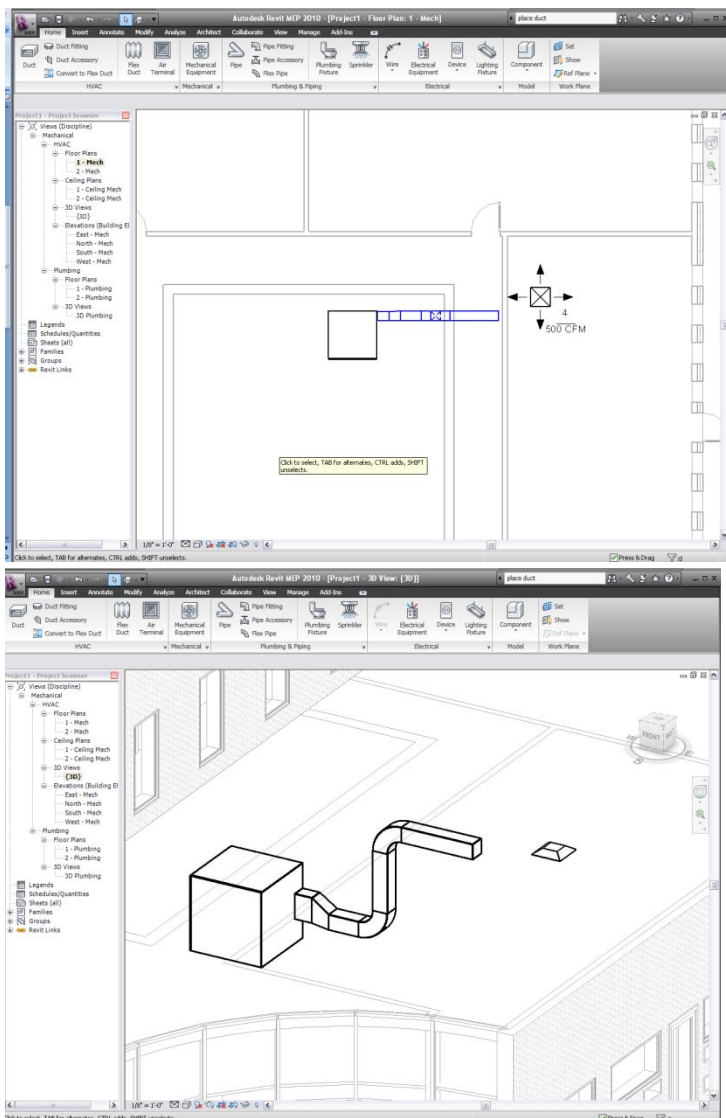

Click on Home tab \Rightarrow HVAC panel \Rightarrow Flex Duct

Place flex duct from the main duct to the top of the air terminal

Lesson Learned:

It is difficult to place vertical ducts on the section or elevation plan. The 3D plan won't let you do any duct editing. Therefore, the best way to draw vertical ducts is to do it on the floor plan or ceiling plan. You should also change to visibility range of the plan to make sure the ducts shows up on the plan.